

Specifications of the cable tray to be used for cable laying

Ladder type Cable trays with side channel of 50x15mm and cross rungs of 35 x 15mm C/c 250 mm with fabricated from 2mm thickness M.S Sheet in the standard length of 2.5 Meters
 Duly Hot dip Galvanized after fabrication inclusive of coupler plate and electro galvanized Hardware (with out cover)-250mm
 Required length :135 Meters+10 % =148.5Meters
 Trays to be mounted by SS anchor fasteners

Ladder type Cable trays with side channel of 50x15mm and cross rungs of 35 x 15mm C/c 250 mm with fabricated from 2mm thickness M.S Sheet in the standard length of 2.5 Meters
 Duly Hot dip Galvanized after fabrication inclusive of coupler plate and electro galvanized Hardware (with out cover)-100mm
 Required length :100Meters
 Trays to be mounted by SS anchor fasteners

Specifications of the Copper Conductors used for Earthing

Purity of copper should be more than 95% for all earth conductors
 Copper Strip of size 25mmW x 3 mm Thickness-60 Meters
 Copper round wire 10 SWG -450 Meters

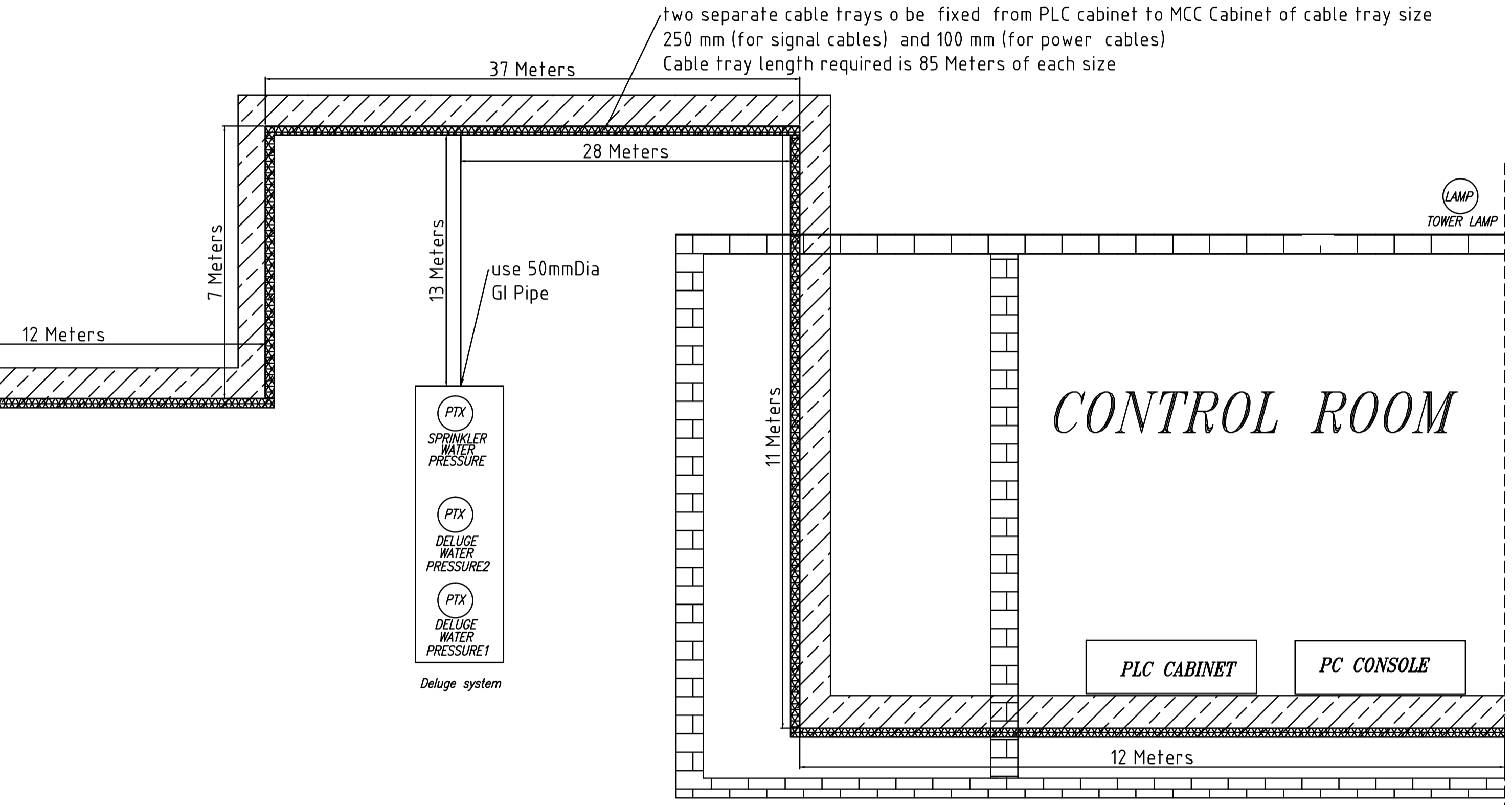
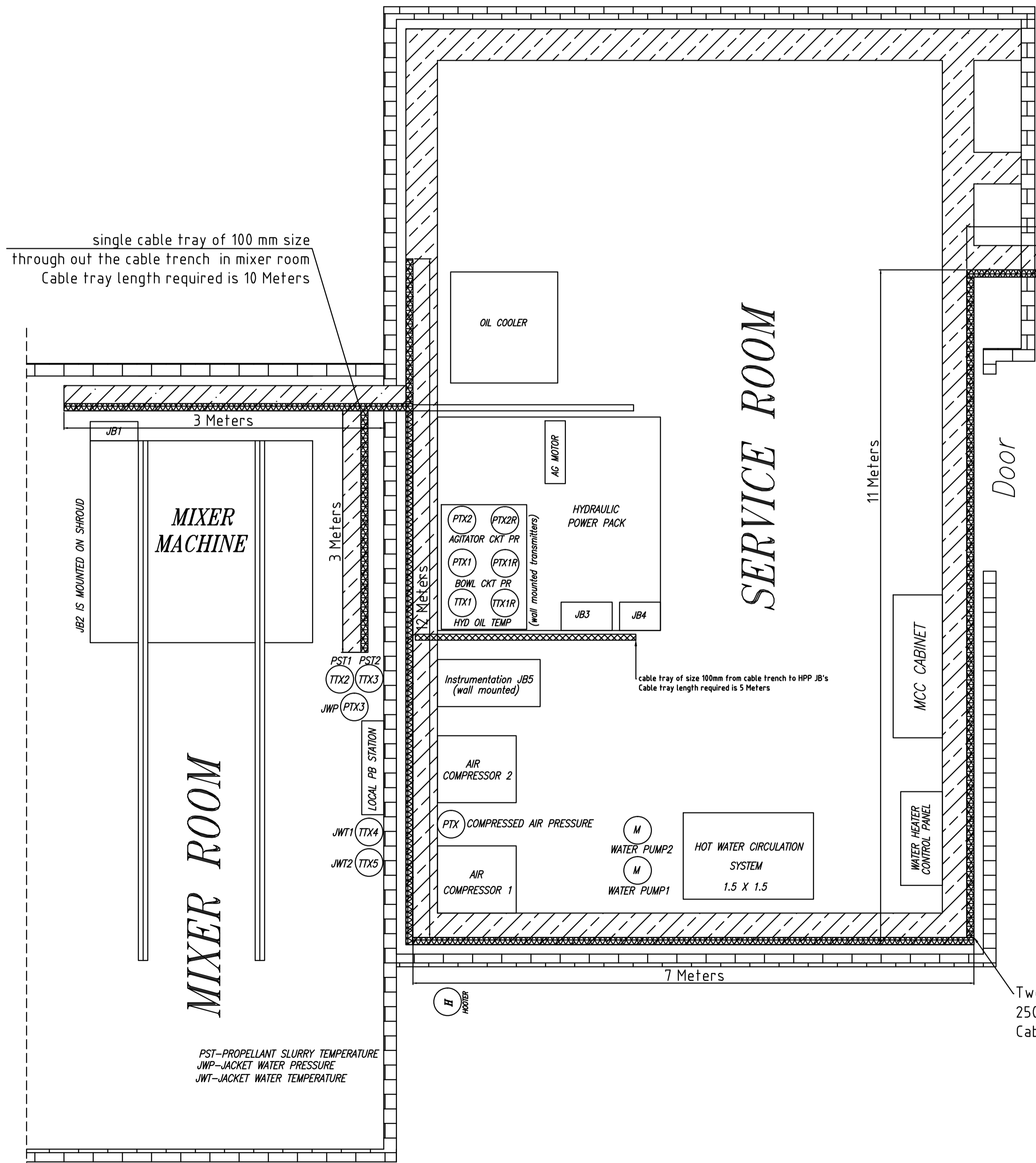

NOTE: Maximum distance from the cable trench to the field element is 5 Meters except below components

- 1.Hooter -20 meters
- 2.deluge system elements-15 Meters
- 3.lower lamp-20meters
- 4.humidity and temperature transmitters @ feeder room -20 meters
- 5.humidity and temperature transmitters @ mixer room -20 meters

Cables shall be clamped at every 1.5 meters on the trays/racks slotted channels in trenches.
 the cables laid on the surface of the wall/floor shall be supported by using clamps/rawl plugs and screws , no wooden plugs shall be used.
 the cables laid on the surface of the wall/floor shall be clamped at the minimum interval of 0.5 m Horizontal run and 1 m in vertical run

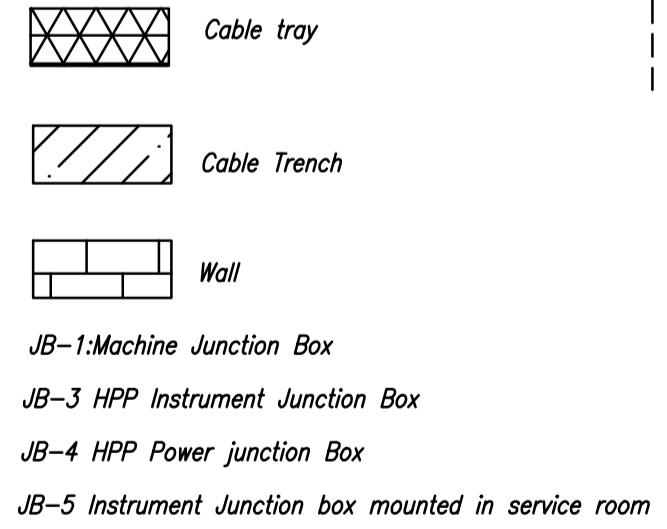

Two separate cable trays to be fixed from MCC Cabinet to other sub systems inside service room of size 250 mm (for signal cables) and 250 mm (for power cables)
 Cable tray length required is 50 Meters of 250mm cable tray

MACHINING DEVIATIONS WHERE NOT SPECIFIED

LENGTH IN mm OF SHORTER SIDE OF ANGLES	LENGTH	upto 6	6 - 30	30 - 120	120 - 400	400 - 1000	1000 - 2000	2000 - 4000	4000 -			
± 1'	± 30'	± 20'	± 10'	OR	± 0.1	± 0.2	± 0.3	± 0.5	± 0.8	± 1.2	± 2	± 3

THIS DRAWING IS THE PROPERTY OF CMTI (A GOVT. OF INDIA SOCIETY). THIS SHOULD NOT BE COPIED OR LENT WITHOUT A WRITTEN AUTHORITY FROM CMTI.

No. of	Stock Size	Semi Product	Material	Net Wt.	Stock Size	30 - 0 - 2
Finish	✓/✓/✓/✓	PROJECTION	HARDNESS	CASE DEPTH	PATTERN NO	Drwg No (Assembly)
Scale	Designed BHUTHESH GN	Checked BHUTHESH GN	Appr. ARUN KUMAR JG	Date		
	Checked MANNASAN M	Standards				
		TYPE VPM-300	GROUP ELECTRICAL	Used in	Alteration	Area Sign Date Index
CMTI TITLE FIELD WIRING SCHEME				Superseded by	GSP1701003	
Central Manufacturing Technology Institute-Bangalore				Replaces	31 - 1 - 6	
					SHEET 2 OF 2	